

## Product Features

Application : - 2-Wheeler (Bi-Cycle)

Motor Type : - Geared Hub Motor

## Motor Specifications

Outer Diameter : - 113 mm

Shaft Length : - 192 mm

Break Size : - Disc

Swing Arm Distance :- 126 mm

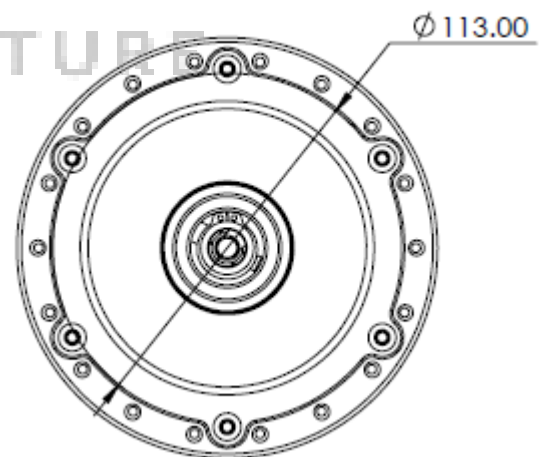
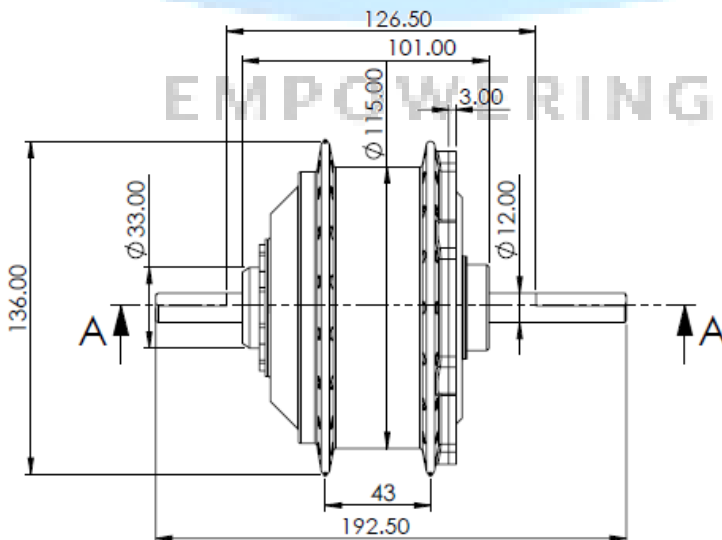
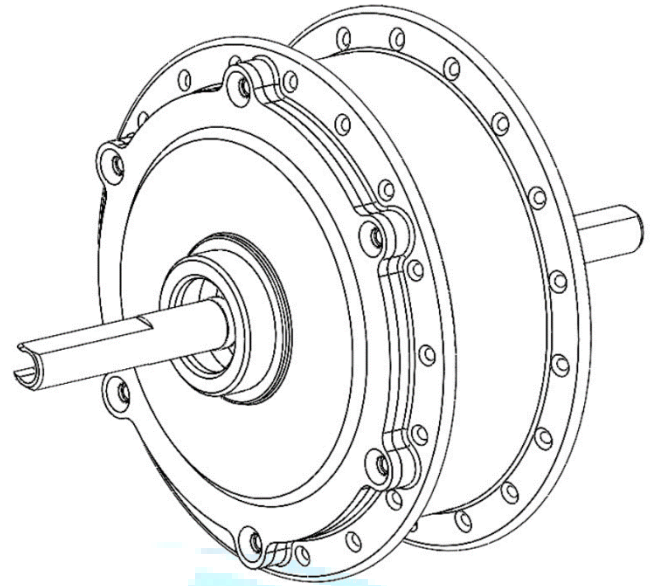

## Motor Specification

Operating Voltage	36	V
Rated Power	250	W
Peak Power	520	W
Rated Torque	10	N-m
Peak Torque	50	N-m
Max DC Current	20	A
Max Speed	255	Rpm

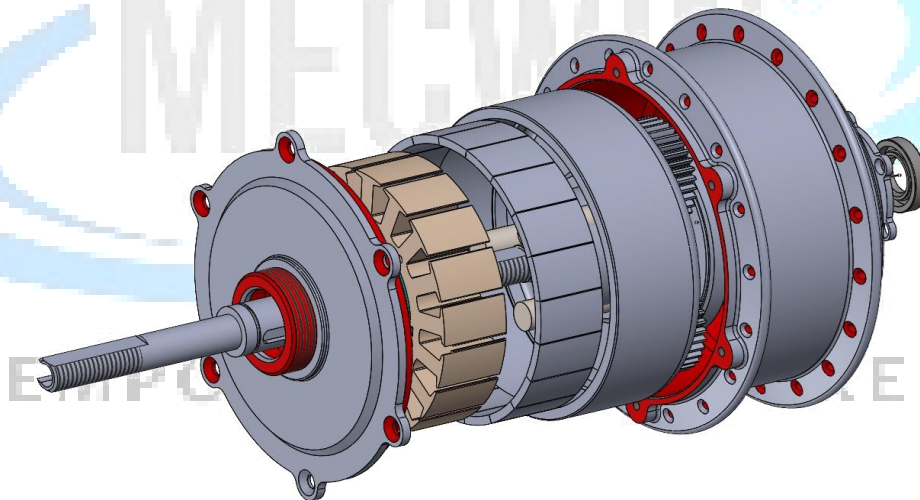
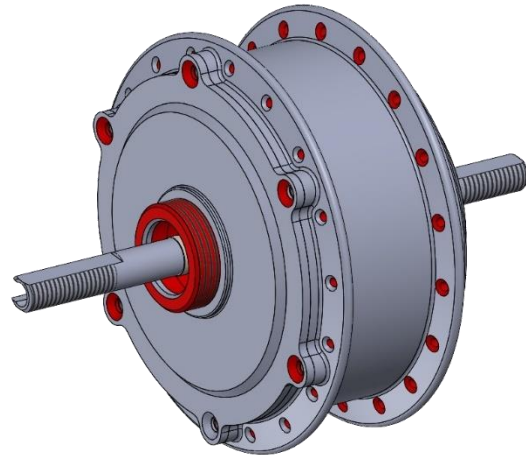

## Performance Details

Parameters	DC Voltage	DC Current	Input Power	Torque	Speed	Output power	System Efficiency
	V	A	W	N-m	rpm	W	%
No Load	36.0	1.3528	48.818	0.0	255.2	0.3171	0.6
Max Torque	36.0	18.688	674.56	50.8	3.0	15.892	2.4
Max Input Power	36.0	20.565	742.29	33.1	139.7	483.72	65.2
Max Output Power	36.0	19.744	712.63	27.4	183.8	526.88	73.9
Max Efficiency	36.0	6.2679	226.25	8.1	234.8	211.32	90.0
s							

## Performance Curves

### Output Power vs Speed

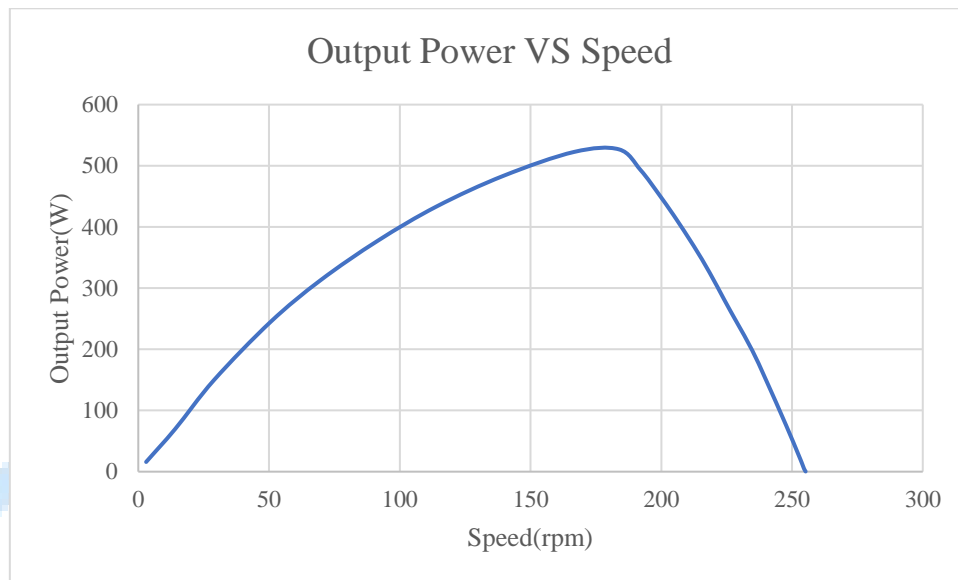

### Torque vs Speed

EMPOWERING FUTURE

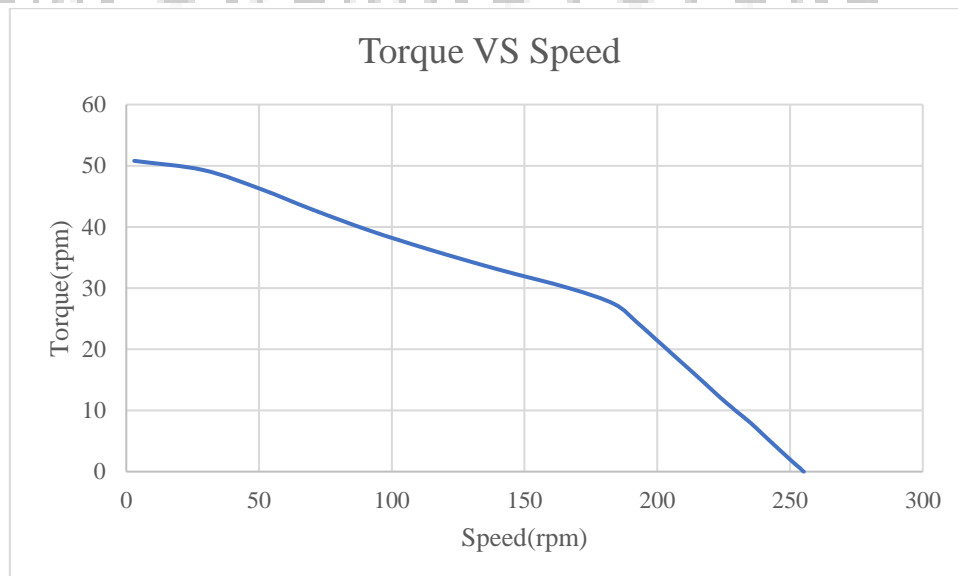

Current vs Speed

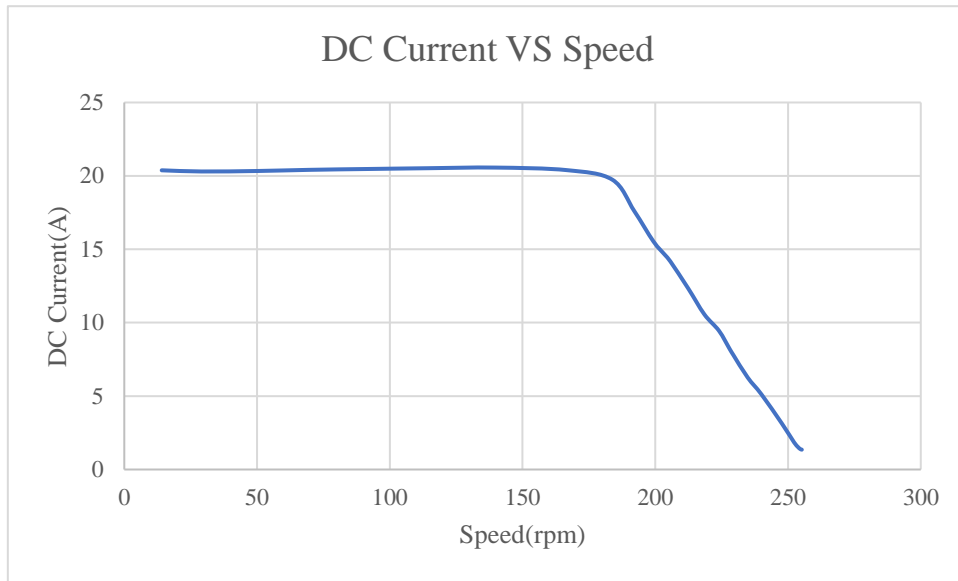

Efficiency vs Speed

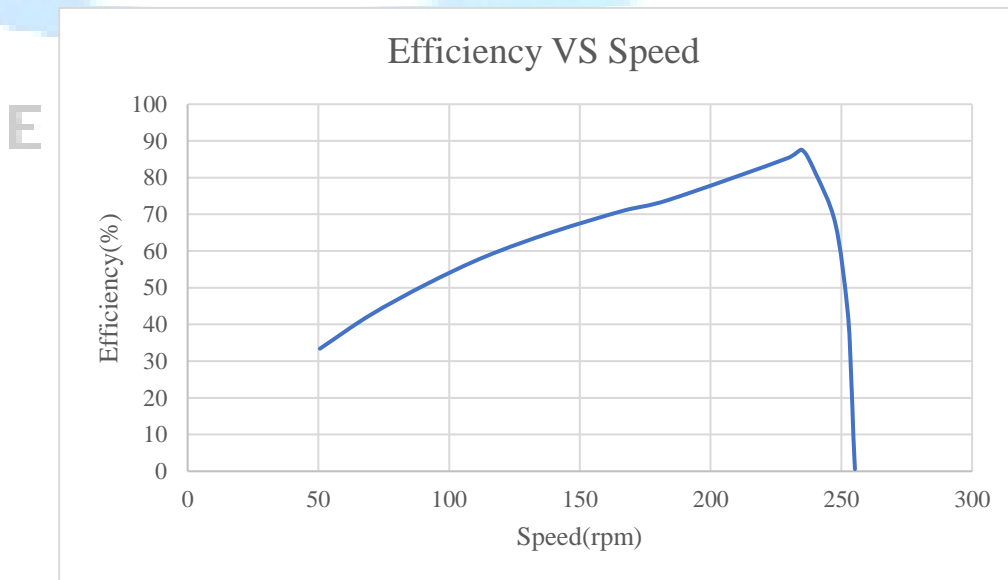

## Load Test Data

DC Voltage	DC Current	Input Power	Torque	Speed	Output Power	System Efficiency
V	A	W	N-m	rpm	W	%
36.087	1.3528	48.818	0.0	255.2	0.3171	0.6
36.085	1.3972	50.420	0.2	254.6	4.8594	9.6
36.076	1.5400	55.556	0.6	253.7	14.888	26.8
36.066	1.8446	66.527	1.1	252.3	29.458	44.3
36.031	3.1301	112.78	2.9	247.7	76.140	67.5
36.095	5.1171	184.70	6.0	240.0	150.41	81.4
36.097	6.2679	226.25	8.1	234.8	211.32	90.0
36.098	7.8029	281.67	10.0	229.4	240.25	85.3
36.098	8.1840	295.43	10.5	228.1	250.00	84.7
36.097	9.4495	341.10	12.0	224.0	281.73	82.6
36.097	10.565	381.36	14.2	218.5	325.27	85.3
36.096	12.337	445.30	16.6	212.4	369.09	82.9
36.095	14.169	511.44	19.2	205.7	413.01	80.8
36.090	14.607	527.16	20.0	203.7	425.54	80.8
36.078	15.538	560.58	21.7	199.3	452.18	80.7
36.091	17.600	635.22	24.5	192.1	492.99	77.6
36.094	19.744	712.63	27.4	183.8	526.88	73.9
36.093	20.392	736.03	30.0	166.7	522.69	71.0
36.095	20.565	742.29	33.1	139.7	483.72	65.2
36.095	20.522	740.73	36.3	114.2	433.77	58.6
36.095	20.470	738.87	39.4	91.7	377.80	51.1
36.104	20.412	736.95	42.9	69.7	312.95	42.5
36.096	20.335	733.99	46.2	50.6	244.87	33.4
36.094	20.301	732.75	49.3	29.0	149.93	20.5
36.094	20.381	735.63	47.2	14.1	69.731	9.5
36.095	18.688	674.56	50.8	3.0	15.892	2.4